

INSTALLMENT SALES PROTEA GLEN X 27

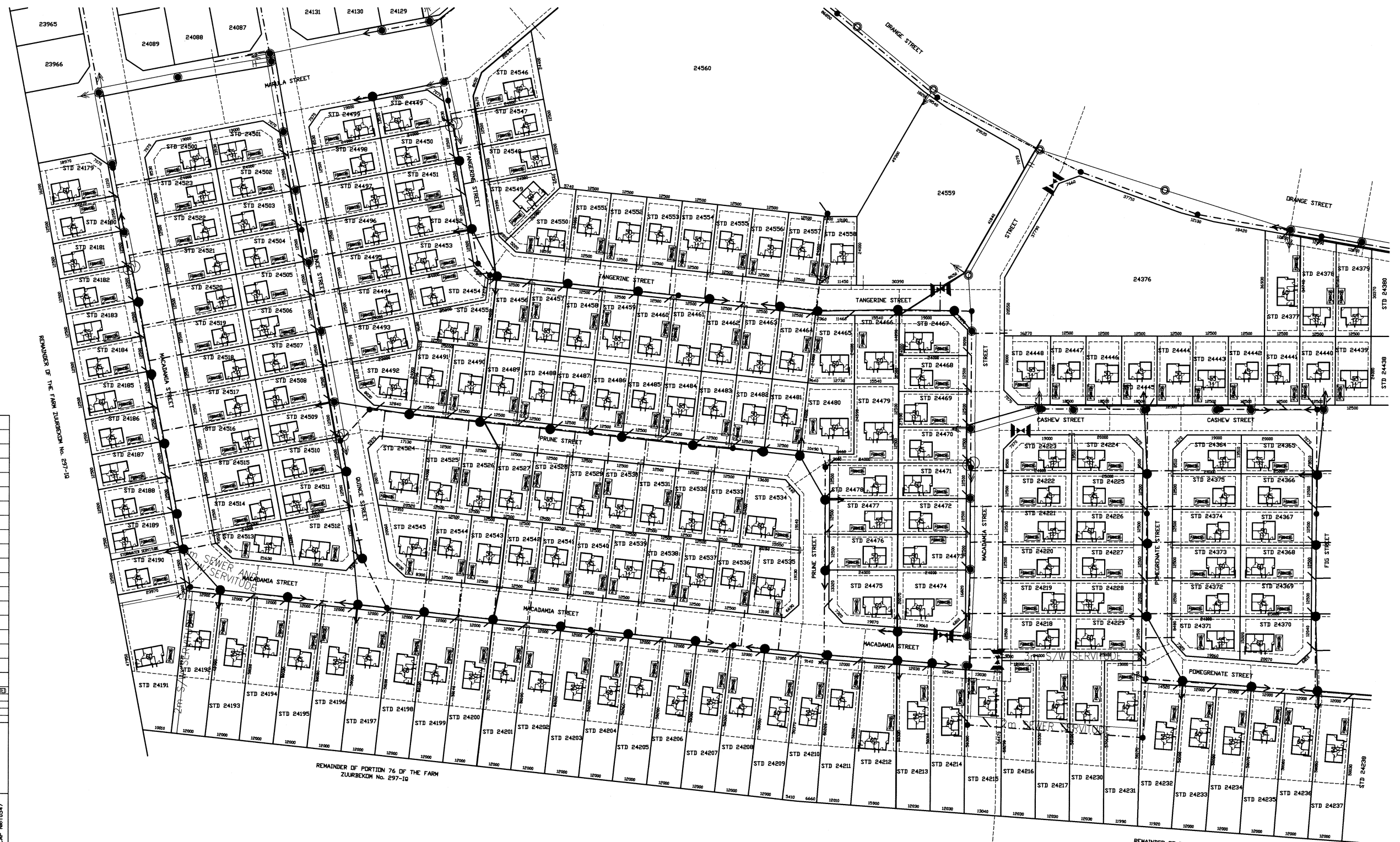
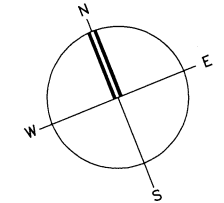

PROTEA GLEN X 27, 379 STANDS	
PHASE 4	
45sqm - 20 UNITS	
50sqm - 7 UNITS	
55sqm - 16 UNITS	
60sqm - 15 UNITS	
PROTEA GLEN X 27, 379 STANDS	
PHASE 5	
45sqm - 30 UNITS	
50sqm - 10 UNITS	
55sqm - 13 UNITS	
60sqm - 14 UNITS	
PROTEA GLEN X 27, 379 STANDS	
PHASE 6	
45sqm - 30 UNITS	
50sqm - 10 UNITS	
55sqm - 15 UNITS	
60sqm - 14 UNITS	
LEGEND	
	BUILDING LINES AS INDICATED
	SEWER SERVICE
	WATER CONNECTION
COSMOPOLITAN	
P.O. BOX 754 AUCKLAND PARK 2006	
TEL: (011) 543 9800 FAX: (011) 515 7955	
ARCHITECTURAL PROJECT	
J.V. Verwey PR. ARCHITECT SACAP: NR10547	
NEW PROPOSED SITE DEVELOPMENT PLAN, PHASE 4, 5 AND 6 PROTEA GLEN X 27	
DRW TITLE: SDP SCALE: 1:500 (A0) 01/06/2012	
SHEET: 01 REV: 7: 04/09/2013 DRAWN: PHS	

REMAINDER OF PORTION 76 OF THE FARM
ZUURBEXIM No. 297-10

REMAINDER OF PORTION 76 OF THE FARM
ZUURBEXIM No. 297-10

[Handwritten Signature] 06/09/2013

INSTALLMENT SALES PROTEA GLEN X 27

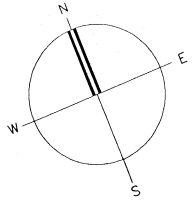

PROTEA GLEN X 27, 379 STANDS

45sqm - 40Z - 151 UNITS

50sqm - 30Z - 114 UNITS

55sqm - 20Z - 76 UNITS

60sqm - 10Z - 38 UNITS

LEGEND

- BUILDING LINES AS INDICATED
- MAIN WATER LINE
- SEWER SERVICE
- MUNICIPAL CONNECTION
- WATER CONNECTION

COSMOPOLITAN

P O BOX 154
AUCKLAND PARK
2006

TEL (011) 543 3800
FAX (011) 315 7995



ARCHITECTURAL PRO SERVICES

P O BOX 88
2006
SOUTH AFRICA

TEL (011) 08 3023
FAX (011) 658 9398

PROTEA GLEN X 27
SACAP NR 10547

NEW PROPOSED SITE
DEVELOPMENT PLAN
PROTEA GLEN X 27

DRW TITLE: SDP SCALE: 1:500 (A0) 01/06/2012

SHEET: 02 REV: 2 - 08/03/2013 DRAWN: PHS

[Handwritten Signature]
9/3/2013